

FOR CONTINUATION.
 SEE DRAWING NO. 0016

FOR CONTINUATION.
 SEE DRAWING NO. 0017

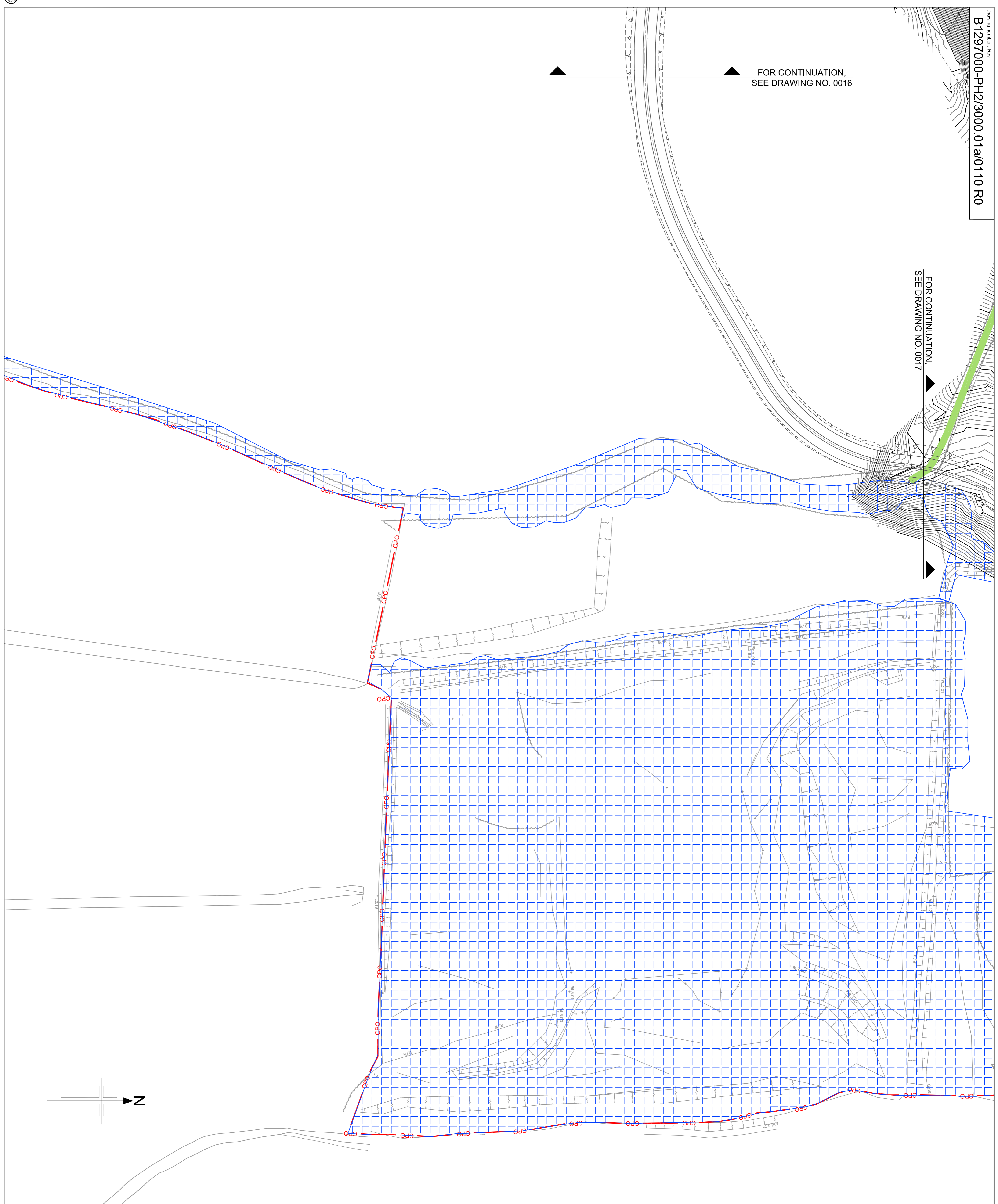

NOTES
 1. Refer to drawing number B1297000/0200.01b/0001 to 0015 for Tree Survey - December 2012 Root Protection Zones.

- KEY**
- Area of managed vegetation to be retained shall be protected by temporary 2m high steel tube and wire mesh fence in accordance with BS 5837. Areas of management vegetation to be retained that are remote from the construction works may be protected by timber post and three wire fence.
 - Area of Hedges, trees, fencelines and scrub
 - Hedge rows and fence lines
- All items to be removed and taken to contractors storeroom off site unless otherwise stated.**

SAFETY, HEALTH AND ENVIRONMENTAL INFORMATION
 In addition to the hazards/risks normally associated with the types of work detailed on this drawing, note the following:

CONSTRUCTION

MAINTENANCE / CLEANING

DECOMMISSIONING / DEMOLITION

It is assumed that all works will be carried out by a competent contractor working, where appropriate, to an approved method statement.

Reproduction from the Ordnance Survey Map with the permission of the controller of Her Majesty's Stationery Office Crown Copyright reserved Licence No. AL 100017326

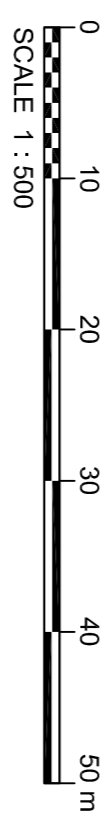

Rev	Rev. Date	INITIAL/ISSUE	ASC	RNS	SSG	RMD
		Purpose of revision	Drawn	Checked	Rev'd	Approved

Client: **JACOBS**
 Simpson House, 6 Cherry Orchard Road, Gorton, Surrey, CR8 6BE
 Tel: +44(0)2081 666 8212 Fax: +44(0)2081 681 2459
 www.jacobs.com

Employer: **HOCHTIEF TRAVLER**
 LAND CONSTRUCTION
 oxford@travler.com

Project: **BEXHILL TO HASTINGS LINK ROAD**

Drawing title
**PLANNING CONDITION 14
 VEGETATION CLEARANCE
 SHEET 30 OF 35**

Drawing status
ISSUE FOR REVIEW

Scale	1:500 @ A1	DO NOT SCALE
Jacobs No.	B1297000-PH2	
Client no.		
Drawing number	B1297000-PH2/3000.01a/0110	Rev
	R0	

This drawing is not to be used in whole or part other than for the intended purpose and project as defined on this drawing. Refer to the contract for full terms and conditions.